

## CLIMASOL FLAT PLATE COLLECTOR

Type	Climasol 1.75	Climasol 2.00	Climasol 2.50	Climasol 2.70
Collector Surface	1.76m <sup>2</sup>	1.91m <sup>2</sup>	2.31m <sup>2</sup>	2.68m <sup>2</sup>
Aperture Surface	1.59m <sup>2</sup>	1.73m <sup>2</sup>	2.12m <sup>2</sup>	2.46m <sup>2</sup>
Absorber Surface	1.57m <sup>2</sup>	1.71m <sup>2</sup>	2.09m <sup>2</sup>	2.42m <sup>2</sup>
Dimensions	1760x1000x86mm	1970x970x86mm	1970x1175x86mm	2145x1248x86mm
Weight	38 kg	41kg	49kg	55kg
Fluid content	1.30 lit	1,36lit	1,64lit	1,86lit

### Technical Specifications

Frame	Aluminum profile epoxy powder coated. Free of screws and rivets.		
Cover	Tempered low iron prismatic glass 4 mm. 88,5 % transmission.		
Sealing	EPDM Rubber - Silicon		
Insulation	Rockwool 40mm (50kg/m <sup>3</sup> ) back and Glass wool 20 mm (30kg/m <sup>3</sup> ) sides		
Absorber Material	Copper full face sheet 0,20 mm thickness Welded to copper pipe with ultrasonic or laser welding.		
Absorber coating	Sputtering blue selective surface		
Absorption ( $\alpha$ )	95% ( $\pm 0.02$ )		
Emissivity ( $\epsilon$ )	5% ( $\pm 0.02$ )		
Efficiency	$\eta_0 = 72.3\%$		
Max. working pressure	600kPa		
Max. working temperature	150°C		

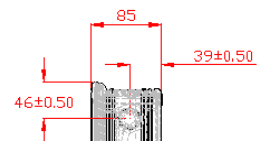

A (1 : 5)